

# DOGA SLIDER SERIES

## SUSPENDED TORQUE REACTION ARMS

The DOGA Slider series is a compact and lightweight alternative for situations where a flexible solution is needed for both vertical and horizontal tightening from above. The Slider series can be mounted to existing overhead rail tracks or, alternatively, can utilize the same rail system as carbon fiber telescopic arms.

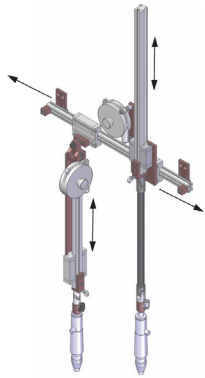

SLIDER 8 COMPACT  
SLIDER 8/20

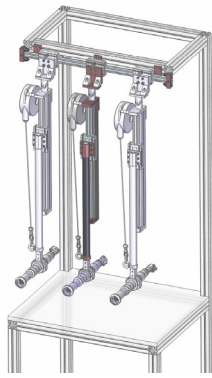

SLIDER 50/150 COMPACT



SLIDER 300 COMPACT

Torque Arm	Max. Torque Nm	Tool Ø mm	Vertical Stroke mm	Max. Working Radius mm	Max. Load kg	Item
SLIDER 08	8	1/4" G	450	100	1,2	4-5283148
SLIDER 08 COMPACT	8	1/4" G	250	150	1,2	4-5283150
SLIDER 20	20	1/4" G	450	100	2,2	4-5283149
SLIDER 50 COMPACT 470	50	32 - 52	450	-	3	4-5283154
SLIDER 50 COMPACT 670	50	32 - 52	650	-	3	4-5283155
SLIDER 50 COMPACT 870	50	32 - 52	850	-	3	4-5283156
SLIDER 150 COMPACT 600	150	Max 63	600	-	5	4-5283113
SLIDER 150 COMPACT 800	150	Max 63	800	-	5	4-5283114
SLIDER 150 COMPACT 1000	150	Max 63	1000	-	5	4-5283115
SLIDER 300 COMPACT	300	Ask	Ask	Ask	Ask	Ask

### CLAMPS

Torque Arm	Capacity Ø (mm)	Item
<b>For Straight Nutrunners</b>		
Slider 20	28/52	4-5283161
Slider 20 Extension kit for MD series		4-5250518
<b>Cardan Clamp For Angle Nutrunners</b>		
Slider 20	28/52	4-5283162
Slider 50	32/52	4-5283163
<b>Fixed Clamp</b>		
Slider 20	28/52	4-5283164
<b>Rotating Clamp</b>		
Slider 20	max. 43	4-5283166
Slider 50	max. 50	4-5283167
<b>Tilt Interface</b>		
15° Slider 20	-	4-5283168
30° Slider 20	-	4-5283169
<b>Tilting Clamp</b>		
18° Slider 50	32/52	4-5283165
<b>Tilting And Rotating Clamp</b>		
18° Slider 50	max. 50	4-5283170



For Straight Nutrunners



Cardan Clamp For Angle Nutrunners

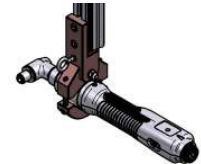

Fixed Clamp



Rotating Clamp

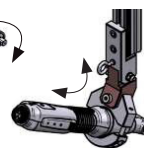

Tilt Interface

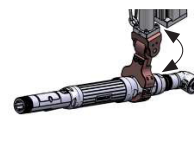

Tilting Clamp

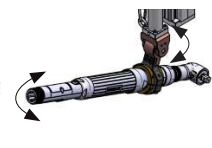

Tilting And Rotating Clamp